

Technical data sheet

Cap nut cable gland, EX area, PG thread, black

Item no. 2050102



Cable gland with EG design type approval certificate for products and protection systems for use in accordance with the regulations in explosion-hazard area. Directive 94/9/EC.

EC design type approval certificate number: PTB 99 ATEX 3112X and ... 3113X.

With PG connection thread according to IEC 423.

Robust cap-nut cable gland with large sealing area, as well as strain relief and torsion protection for high sealing demands.

Sealing ring of chloroprene/nitrile rubber, moulded sealing, so no connection thread sealing ring needed, VDE-tested.

Protection rating IP 68 at 5 bar.



PA Polyamide

Master data

| | |
|--------------------------|----------------------|
| Item no. | 2050102 |
| Type | VTEC EX PG48 SW |
| Description 1 | Cable gland, EX area |
| Dimension | PG48 |
| Colour | Black |
| Material | Polyamide |
| Material symbol | PA |
| Smallest sales unit (VG) | 5,00 Piece |
| Weight | 9,46 kg/100 pc. |

Technical data sheet

Cap nut cable gland, EX area, PG thread, black

Item no. 2050102



Technical data

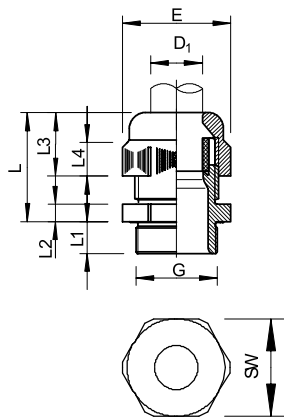

| | |
|------------------------------------|-------------------------------------|
| Dimension E | 74,00 mm |
| Dimension L min. | 42,00 mm |
| Dimension L max. | 58,00 mm |
| Dimension L1 | 14,00 mm |
| Dimension L2 | 9,00 mm |
| Dimension L3 | 33,00 mm |
| WAF | 65,00 mm |
| Version | Straight |
| Type of seal | Sealing ring |
| Bend protection | <input type="checkbox"/> |
| Sealing range D | 30,00 - 44,00 mm |
| explosion-proof | <input checked="" type="checkbox"/> |
| Flat cable threaded connection | <input type="checkbox"/> |
| For Ex zone gas | 1, 2 |
| For Ex zone dust | 21, 22 |
| Thread | Pg 48 |
| Thread type | PG |
| Thread length | 14,00 mm |
| Thread increase | 1,50 mm |
| Nominal thread size | 48,00 |
| Fibre-glass reinforced | <input type="checkbox"/> |
| Halogen-free | <input checked="" type="checkbox"/> |
| Multiple sealing insert | <input type="checkbox"/> |
| With locknut | <input type="checkbox"/> |
| Impact-resistant | <input type="checkbox"/> |
| Hexagonal corner dimension | 74,00 mm |
| Protection rating | IP68 |
| Splittable gland | <input type="checkbox"/> |
| max. permitted ambient temperature | -20,00 - 65,00 °C |
| Strain relief option | <input checked="" type="checkbox"/> |