

Technical data sheet

MS4022 mounting rail, heavy duty, slot 18 mm,
perforated
Item no. 1121979



Heavy-duty C profile rail for individual installation of support constructions, e.g. for cable trays or as a panel for switchgear cabinets. Can also be used for cable routing, in conjunction with clamp clips with a U foot.



| | |
|----|--------------------|
| St | Steel |
| FT | Hot-dip galvanised |

Master data

| | |
|--------------------------|-----------------------|
| Item no. | 1121979 |
| Type | MS4022P2000FT |
| Description 1 | Profile rail |
| Description 2 | perforated, slot 18mm |
| Dimension | 2000x40x22,5 |
| Material | Steel |
| Material symbol | St |
| Surface | Hot-dip galvanised |
| Surface to DIN | DIN EN ISO 1461 |
| Surface symbol | FT |
| Smallest sales unit (VG) | 2 m |
| Weight | 152,50 kg/100 m |

Technical data

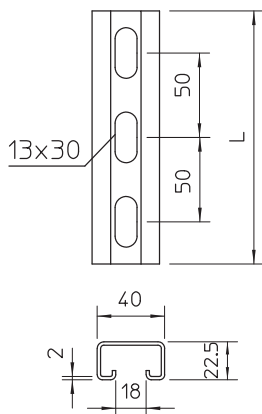

| | |
|--|-------------------------------------|
| Length | 2.000,00 mm |
| Width | 40,00 mm |
| Height | 22,50 mm |
| Dimension L | 2.000,00 mm |
| Breakable | <input type="checkbox"/> |
| lampDimension WxH | 40 x 22,5 mm |
| Version | Single profile |
| Type of perforation | Perforated back |
| Drill hole spacing, centre | 50,00 mm |
| Suitable for maintaining electrical function | <input checked="" type="checkbox"/> |
| Material thickness | 2,00 mm |
| With perforation | <input type="checkbox"/> |
| With tothing | <input type="checkbox"/> |
| Profile shape | C profile |
| Slot width | 18,00 mm |
| Static value A | |
| Static value ly | |
| Static value lz | |
| Static value Wy | |
| Static value Wz | |