

# Technical data sheet

Flat cable threaded connection, metric thread M25,  
stone grey  
Item no. 2013007



Flat-cable entry, choke-nipple design with metric connecting thread to IEC 432, protection rating IP31, with pre-mounted support sealing ring 107/F.



PE Polyethylene

## Master data

Item no.	2013007
Type	106 FL M25 8 33
Description 1	Flat cable threaded connection
Dimension	M25
Colour	Stone grey
RAL number	7030
Material	Polyethylene
Material symbol	PE
Smallest sales unit (VG)	25 Piece
Weight	2,63 kg/100 pc.

## Technical data

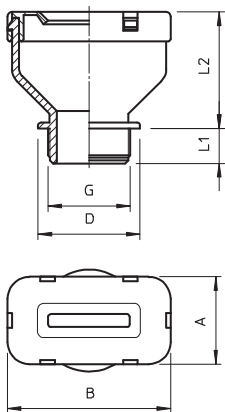

Flat cable/width	30,00 - 33,00 mm
Dimension A	30,00 mm
Dimension B	56,00 mm
Dimension D	35,00 mm
Dimension G	M25 mm
Dimension L	52,00 mm
Dimension L1	12,00 mm
Dimension L2	40,00 mm
Version	Straight
Type of seal	Sealing ring
Bend protection	<input checked="" type="checkbox"/>
explosion-proof	<input type="checkbox"/>
Flat cable/thickness	6,00 - 8,00 mm
Flat cable threaded connection	<input checked="" type="checkbox"/>
For Ex zone	Without
Thread	M25
Thread type	Metric
Fibre-glass reinforced	<input type="checkbox"/>
Multiple sealing insert	<input type="checkbox"/>
With locknut	<input type="checkbox"/>
Impact-resistant	<input type="checkbox"/>
Protection rating	IP31

# Technical data sheet

Flat cable threaded connection, metric thread M25,  
stone grey  
Item no. 2013007



## Technical data

Strain relief option