

Technical data sheet

GES6 service outlet with locking slider

Item no. 7405323



Service outlet with locking slider for up to 9 individual Modul 45 devices in 3 UT3 universal supports, use in duct systems and system floors for indoor use. Floor covering recess in the hinged cover pre-adjusted to 5 mm, if necessary adjustable to 3, 8 or 10 mm.



PA Polyamide

Additional product text, instruction	Up to 6 installation devices with 50 mm central plate can be inserted.
Additional product text 1	

Master data

Item no.	7405323
Type	GES6-2U10T 1019
Description 1	Service outlet
Description 2	for universal mounting
Dimension	274x221x66
Colour	Grey-beige
RAL number	1019
Material	Polyamide
Material symbol	PA
Smallest sales unit (VG)	1,00 Piece
Weight	138,00 kg/100 pc.

Technical data

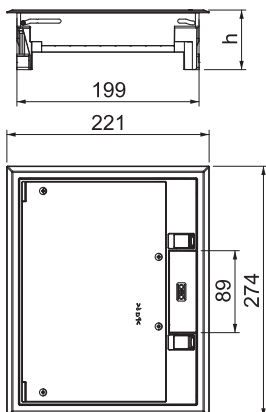

Wide installation dimensions	253,00 mm
Length of installation dimensions	201,00 mm
Number of installable devices	9,00
Number of mounting boxes	3,00
Floor covering thickness	10,00 mm
Floor covering protection frame	<input checked="" type="checkbox"/>
Floor care	Dry
Version for	Rectangular
Seal installation option	<input type="checkbox"/>
Installation depth	73,00 mm
Floor height	73 mm
Device support to accept mounting boxes	<input checked="" type="checkbox"/>
Suitable for wet care	<input type="checkbox"/>

Technical data sheet

GES6 service outlet with locking slider

Item no. 7405323



Technical data

Suitable for raised floor installation	<input checked="" type="checkbox"/>
Suitable for cavity floor installation	<input type="checkbox"/>
Suitable for underfloor ducts	<input checked="" type="checkbox"/>
With floor covering recess	<input checked="" type="checkbox"/>
Nominal size for device installation units	6
Suitable for underfloor box	250/350
Opening mechanism	Locking slider
Frame version	Carpet protection frame
Schwerlastausführung	<input type="checkbox"/>
Typ des Einbausystems	UT3
Approvals	VDE