

Technical data sheet

Adjustable connector 60

Item no. 6208944

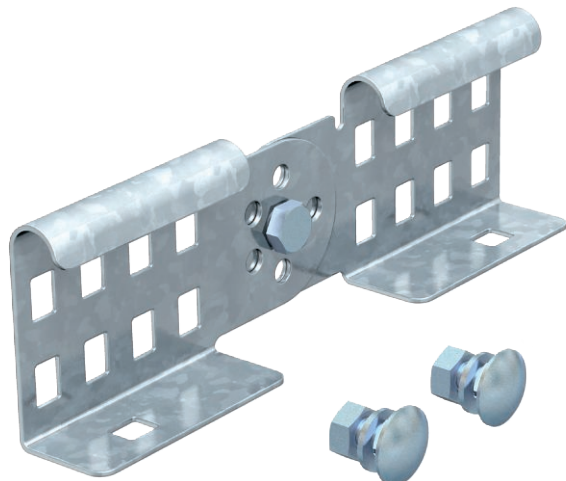

Adjustable connector as external connector to join cable ladders and fittings with a side height of 60 mm and continuous rail perforation. Angle can be adjusted vertically.

The bolt fastening ensures the continuity of the equipotential bonding.



- St** Steel
- FT** Hot-dip galvanised

Master data

Item no.	6208944
Type	LGVG 60 FT
Description 1	Adjustable connector
Description 2	for cable ladder
Dimension	64x210
Material	Steel
Material symbol	St
Surface	Hot-dip galvanised
Surface to DIN	DIN EN ISO 1461
Surface symbol	FT
Smallest sales unit (VG)	10 Piece
Weight	29,90 kg/100 pc.

Technical data

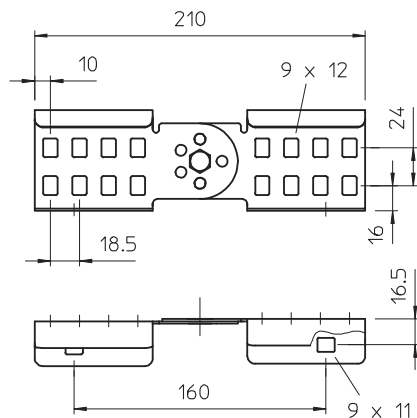

Length	210,00 mm
Width	28,00 mm
Height	64,00 mm
Side height	60,00 mm
Dimension	64x210 mm
Version	Straight and angle connector
Plate thickness	1,50 mm
Suitable for cable tray system height	60,00 mm
Suitable for cable tray	<input type="checkbox"/>
Suitable for mesh cable tray	<input type="checkbox"/>
Suitable for cable ladder	<input checked="" type="checkbox"/>
Adjustable connector, horizontal	<input type="checkbox"/>
Adjustable connector, vertical	<input checked="" type="checkbox"/>
Rustproof steel, pickled	<input type="checkbox"/>
Connection type	Screw connector