

Technical data sheet

Mounting plate for FireBox T series

Item no. 7205480



Mounting plate for the fastening of junction boxes of the FireBox T series (with external fastening) onto cable trays or cable ladders with a side height of 60 mm. The angled construction from sheet steel reinforced through crimps enables the secure mounting of cables that maintain electrical functionality, without having to bend the cable over the side rail.

- St** Steel
- DD** Strip galvanised zinc/aluminium, Double Dip

Master data

Item no.	7205480
Type	MP T610
Description 1	Mounting plate FireBox T100
Description 2	for cable support systems
Dimension	185x52x141
Material	Steel
Material symbol	St
Surface	Strip galvanised zinc/aluminium, Double Dip
Surface to DIN	DIN EN 10346
Surface symbol	DD
Smallest sales unit (VG)	1 Piece
Weight	23,60 kg/100 pc.

Technical data

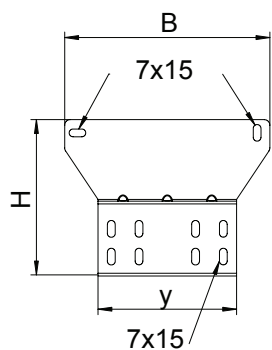

Width	185,00 mm
Height	141,00 mm
Dimension B	185,00 mm
Dimension H	141,00 mm
Dimension x	52,00 mm
Dimension y	125,00 mm
Version	horizontal
Fastening type	Screw fastening
Rustproof steel, pickled	<input type="checkbox"/>