

Technical data sheet

Stainless steel sleeve V4A

Item number: 2046772



Accessory part: plug-in sleeve for the connections between electrical installation pipes. With burr-free inner wall.



A4 Stainless steel

2B Bright, treated

Master data

Item number	2046772
Type	SV25W A4
Description 1	Stainl.steel connection sleeve
Description 2	without thread
Manufacturer	OBO
Dimension	Ø25mm
Material	Stainless steel 1.4571
Surface	Bright, treated
Surface standard	
Smallest sales unit	15
Unit of quantity	Piece
Weight	3.9 kg
Weight unit	kg/100 pc.
CO2 Footprint (GWP) Cradle-to-Gate	0,2241 kg CO2e / 1 Piece

Technical data sheet

Stainless steel sleeve V4A

Item number: 2046772



Dimensions

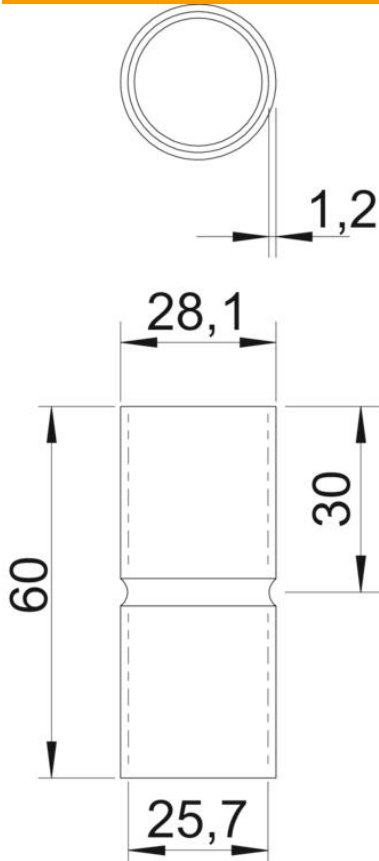

Length	60 mm
Dimension D	27.2 mm
Dimension d	25.2 mm
Dimension L	60 mm
Dimension l	30 mm
Dimension m (mm)	M25
Dimension t	1 mm

Technical data

Version for pipe diameter	25 mm
Size	25
Halogen-free	yes
With inspection opening and lid	no
Brushed surface	yes
Polished surface	no
Permitted temperature range, max.	400 °C
Permitted temperature range, min.	-45 °C
Two-part	no