

# Technical data sheet

## Clamp clip, single, FT metal pressure trough

Item number: 1156004



Suitable for all C profile rails with slot width 16–17 mm.  
Clip, bolt and pressure trough made of hot-dip galvanised steel.  
Version with welding and/or locknuts for use under difficult circumstances and for  
shake protection on request.



St	Steel
FT	Hot-dip galvanised

### Master data

Item number	1156004
Description 1	Clamp clip
Description 2	with metal pressure sump
Manufacturer	OBO
Dimension	8-12mm
Material	Steel
Surface	Hot-dip galvanised
Surface standard	DIN EN ISO 1461
Smallest sales unit	100
Unit of quantity	Piece
Weight	3.2 kg
Weight unit	kg/100 pc.
CO Footprint (GWP) Cradle-to-Gate	0,0645 kg COe / 1 Piece

# Technical data sheet

## Clamp clip, single, FT metal pressure trough

Item number: 1156004



### Dimensions

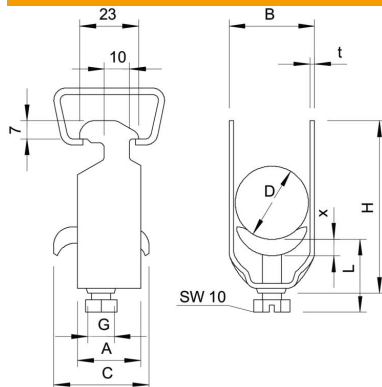

Dimension A	23 mm
Dimension B	16 mm
Dimension C	30 mm
Dimension G (mm)	M6
Dimension H	40 mm
Dimension L	32.5 mm
Dimension t	1.5 mm
Dimension x	3.5 mm

### Technical data

Number of cables/pipes	1
for 1 cable H	40 mm
for 1 cable L	32.5
for rail with slot width (with interval), max.	17 mm
for rail with slot width (with interval), min.	16 mm
Halogen-free	no
Max. Tightening torque	3 Nm
With plastic trough	no
With metal trough	yes
Mounting type	Profile rail
Impact-resistant	no
Clamping range D, max.	12 mm
Clamping range D, min.	8 mm
Surface addition	hot galvanised
Material addition	Steel
With counter-trough	no
Material of trough	Steel